



Apt 3, Crown court, Clewer Hill Road, Windsor, SL4 4DW
£360,000

Apt 3, Crown court, Clewer Hill Road, Windsor, SL4 4DW

Nestled on the elevated Clewer Hill Road in Windsor, this exquisite two-bedroom apartment presents a unique opportunity for those seeking a modern and convenient lifestyle. The property is ideally situated close to local amenities, ensuring that everything you need is just a stone's throw away.



Property Summary.

Nestled on the elevated Clewer Hill Road in Windsor, this exquisite two-bedroom apartment presents a unique opportunity for those seeking a modern and convenient lifestyle. The property is ideally situated close to local amenities, ensuring that everything you need is just a stone's throw away.

Upon entering, you will be greeted by a bright and airy atmosphere, enhanced by contemporary design elements that create a welcoming environment. The house boasts high-end integrated appliances, making it perfect for both cooking enthusiasts and those who appreciate modern conveniences.

One of the standout features of this property is the secure, south-facing communal gardens, providing a tranquil outdoor space for relaxation and socialising. Additionally, off-road parking is available, a valuable asset in this desirable area.

Offered with no onward chain, this property is ready for you to move in and make it your own. Whether you are a first-time buyer, a small family, or looking to downsize, this home on Clewer Hill Road is a splendid choice that combines comfort, style, and practicality. Don't miss the chance to view this remarkable property and experience all it has to offer.

Lease information.

Share of Freehold.

Service Charge: £100.00 Per calendar month.

Ground Rent: £20.00 per calendar month.





Crown Court SL4

Approximate Gross Internal Floor Area = 67.6 sq m / 728 sq ft

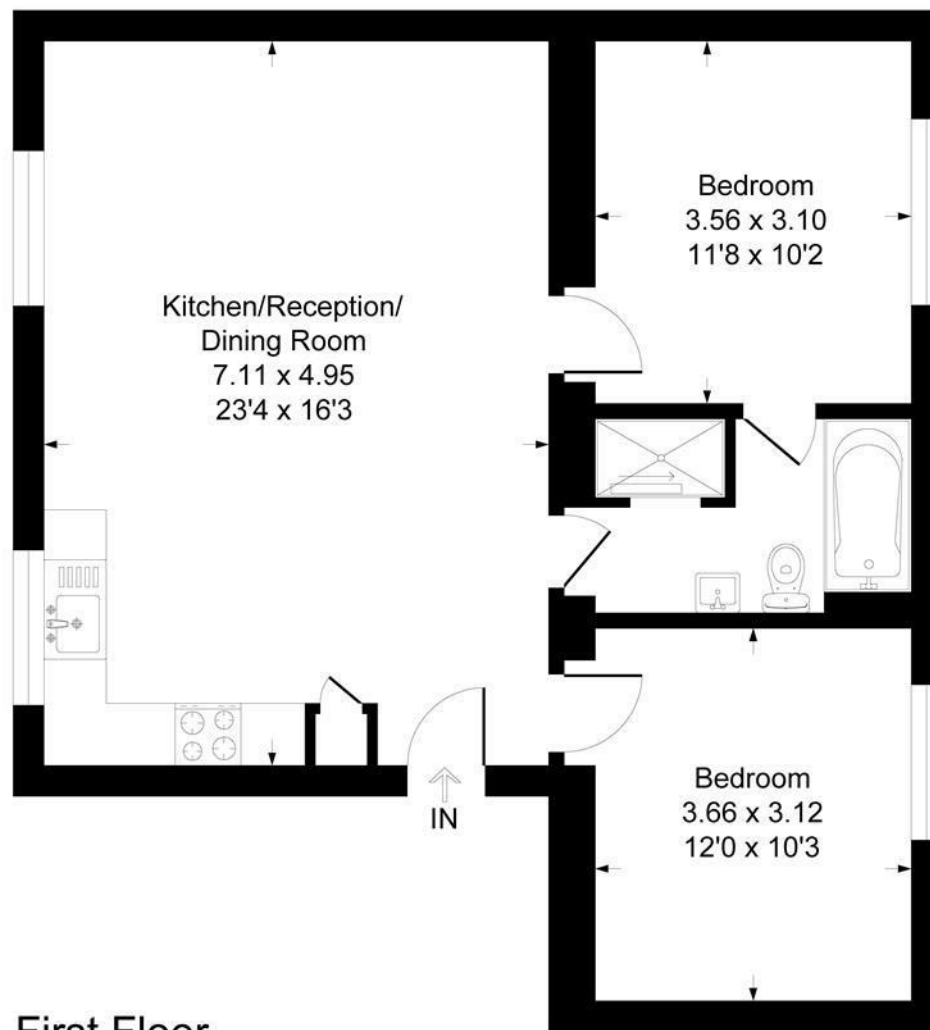

First Floor

Illustration for identification purposes only, measurements are approximate, not to scale.
Produced By Esjay Property Marketing